

Roman Tub Set Installation Instructions with Diverter / Hand Shower Option



LEAVE FOR HOME OWNER

All of our products satisfy all ANSI/ASME test requirements for USA.

TESTED TO:
ASME A112.18.1/CSA B125.1-2011/ASSE 1016
NSF/ANSI 61-2011a and NSF 372 - 2010

FLOW RATES:
SHOWER HEADS 2.0 GPM/7.56 L/min,
AERATORS 1.5GPM/5.7 L/min

Our products comply with Section 9 of NSF 61 criteria concerning lead content.

Care Instructions:

The Product you have just purchased is designed to provide you with long lasting beauty and dependability. To ensure your product's longevity, please follow the following care instructions. When installing, we recommend you lay all parts on a soft cloth or towel to avoid scratching or damaging the product. Never use abrasive cleansers, sponges, or acidic cleaning products as these may damage the finish and VOID THE WARRANTY.

CAUTIONS

- Take special care to protect all components during the construction and installation.
- Before removal of old faucet, always turn off water.
- Open the faucets to reduce water pressure and to insure that complete water shut off has been accomplished.
- Before faucet installation, carefully flush all water lines.
- After faucet installation, remove aerator and flush all water lines again.
FAILURE TO DO SO MAY DAMAGE INTERNAL PARTS!
- Plumber's putty is not recommended. Use of caustic substances may harm the finish or cause the product to not function properly.

Note: This fitting has been factory assembled, tested and is ready for installation.

Recommended Installation Instructions:

Read all instructions completely before proceeding!

Step 1:

Insert spout shank through the hole in the deck. Place mounting nut over the shank and tighten from the underside of the deck. Then screw on the tee connection* as shown in Figure 1.

*When using diverter hand shower set, do not use a connection tee, **SEE DIVERTER INSTALLATION.**

Step 2:

The **RED** marked valve is the **HOT** side, and the **BLUE** marked valve is the **COLD** side. Spin the bottom valve mounting nut all the way down the valve and remove the top nut. Insert valve bodies up through the holes in the deck, then drop on the top mounting nut. Thread on the nuts while adjusting valve height so that **Measurement A** is 1-5/8" as shown in Figure 2.

Step 3:

Test the previous height by temporarily placing the handle pieces over the valve. After you have checked the fitting, remove handle pieces and tighten the mounting nuts with a wrench. **See Figure 3.**

Step 4:

Remount handle and two piece escutcheon. Remove handle cap and tighten the screw into the top of the valve. Replace handle cap. Finished handle trim height should measure 3-5/8" as shown in Figure 4. The handle should open and close in a 1/4 turn.

Step 5:

It is recommended that you plumb supply lines to the valve bodies and all other connections using 3/4" L-soft copper tubing. When finished, be sure to check system for leaks.

⚠ CAUTION: DO NOT APPLY HEAT OR TORCH TO THE VALVES OR SPOUT BODY.

Valve Care:

Your 1/4 turn ceramic valve will provide you with a lifetime of un-failing service, when cared for properly. The most common valve problem is a result of debris in the water line, such as sand, silt, solder, metal shavings, lime deposits, or other foreign particles. Debris can become lodged between the ceramic discs and result in improper functioning of the open and close action of the valve. Particles can even cause cracks in the discs and render the cartridge useless. **TO CLEAN CARTRIDGE, SEE ATTACHED INSTRUCTIONS.**

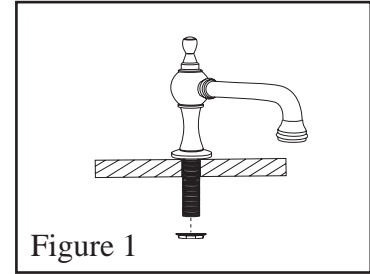

Figure 1

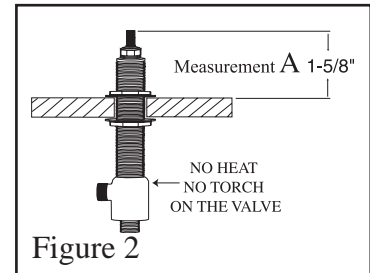

Figure 2

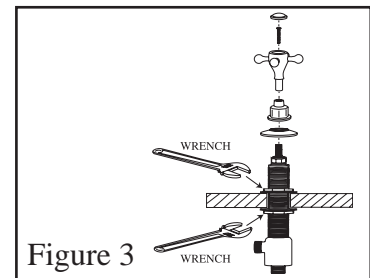

Figure 3

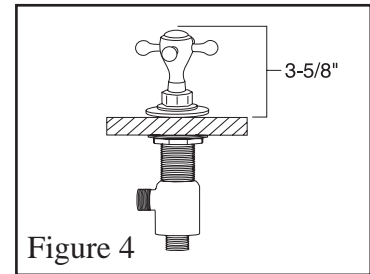

Figure 4

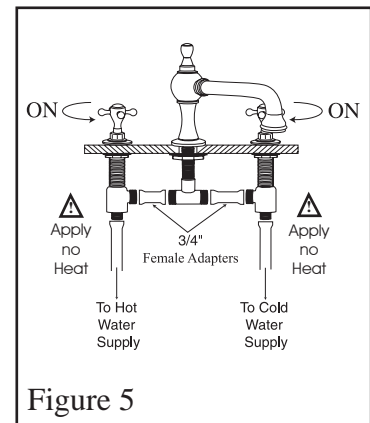

Figure 5

Optional Diverter / Hand Shower Installation

Step 1:

Insert spout shank through the hole in the deck. Place mounting nut over the shank and tighten from the underside of the deck.

Step 2:

Spin the bottom valve mounting nut all the way down the valve and remove the top nut. Insert valve bodies up through the holes in the deck, then drop on the top mounting nut. Thread on the nuts while adjusting valve height so that **Measurement A** is 1-5/8". See Figure 2 of Installation Instructions on Page 2.

Step 3:

Spin the bottom mounting nut all the way down the diverter and remove the top nut. Install spring lift diverter valve through the bottom of hole in the deck. Thread on the nuts while adjusting the diverter height so that the top of the valve is 2" above the finished deck, as shown in the diagram below.

Step 4:

Mount diverter escutcheon pieces on diverter, and tighten over valve.

Step 5:

It is recommended that you plumb supply lines to the valve bodies and all other connections using 3/4" L-soft copper tubing. Pre-solder 3/4" copper tubing to 3/4" male adapters. Using teflon tape on adapters, thread pieces into inlet and outlet of diverter. Copper fittings and adapters are sold separately.



DO NOT APPLY HEAT/TORCH TO DIVERTER VALVE BODY, HOT AND COLD VALVES OR ANY TRIM. THIS WILL CAUSE IRREPAIRABLE DAMAGE.

Step 6:

Using necessary 3/4" male and female copper fittings, plumb in accordance to diagram below.

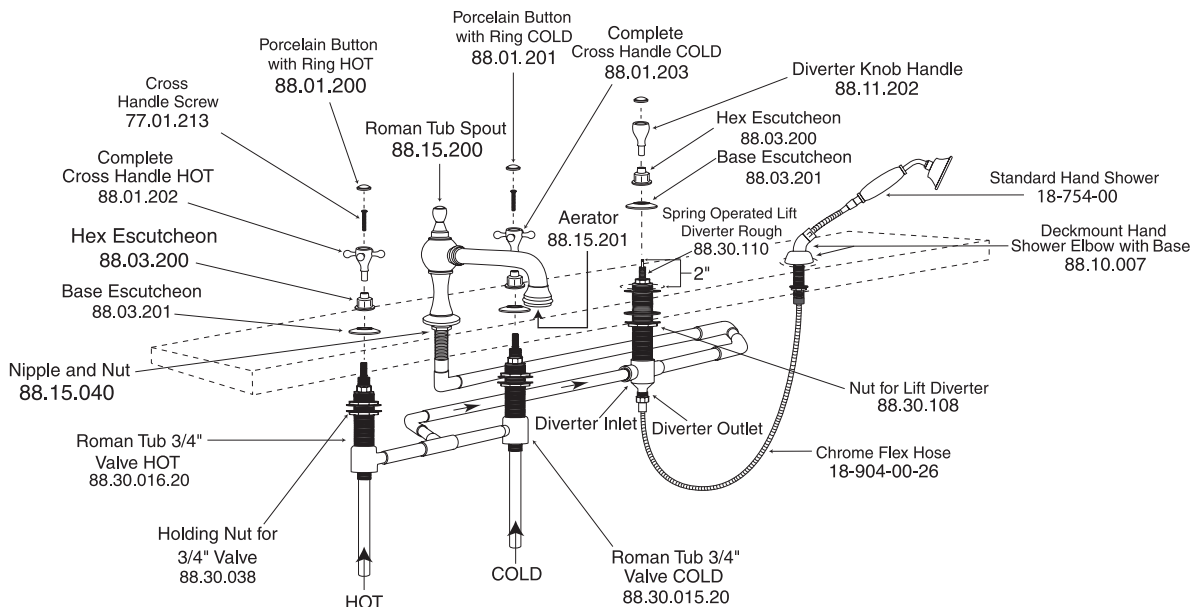

Bluewater Manufacturing Corporation Phone # 877-890-8006 Fax # 877-373-0649

VALVE CARE

Your 1/4 turn ceramic valve will provide you a lifetime of service when cared for properly. The most common valve problem is a result of debris in the water line, such as sand, silt, solder, metal shavings, lime deposits or other foreign particles. Debris can become lodged between the ceramic discs and result in improper functioning of the open and close action of the valve. Particles can even cause cracks in the ceramic discs and render the cartridge useless. For further information, please contact Bluewater Manufacturing Corporation @ 877-890-8006 or fax your request to 877-373-0649

BLUE WATER MANUFACTURING CORPORATION LIMITED PRODUCT WARRANTY

Product/Finish Warranty: Bluewater Manufacturing Corporation warrants that products are free from manufacturing defects in materials and workmanship for five (5) years from date of invoice. In addition, our Finish Warranty provides limited LIFETIME coverage for Chrome & PVD finishes, five (5) years for powder coated finishes & Polished Gold. Living finishes are warranted for workmanship only. If any material proves to be defective after inspection by our company, it will be repaired or replaced at our discretion at no charge. However, no claims for labor, shipping costs, or consequential damages will be accepted.

What we will do: We will restore any product whose finish proves to be defective back to its original finish at no charge during the appropriate warranty period stated above. Proof of purchase must be provided. After the warranty period, **Bluewater Manufacturing Corporation** will refinish any of its faucets at the prevailing appropriate charge.

What you must do: The faucets must be properly installed according to our instructions and specifications and are for residential use only. The faucets cannot be altered in any way. You must maintain and clean the faucets in accordance with the instructions provided with the product. You must use the faucet(s) for residential use only.

How to obtain service: Send your name, address, and telephone number along with a statement describing the nature of the problem and your paid sales slip or other proof of purchase to:

BLUE WATER MANUFACTURING CORPORATION
3280 Corporate View
Vista, CA 92081

We will then contact you and take appropriate action. Do not send us any part(s) of your faucet(s) or its various connecting hoses unless we have contacted you and have sent you an approved RGA form. All transportation charges for returned goods must be paid by the customer.

What is not covered: This warranty does not cover the crystal/glass, or porcelain products of any faucet or the drain assembly or aerator on other than the Chrome or PVD finishes. This warranty also does not cover damage caused by accident, alterations, misuse, abuse, normal wear and tear, lime deposits, direct exposure to salty air or corrosive materials, or the color change that takes place with the passage of time, or use in any manner contrary to **Bluewater Manufacturing Corporation's** printed instructions. Cartridge warranties vary. Please call factory for details. In the case of in-the-wall installations, **Bluewater Manufacturing Corporation** will assume no liability if there is no access. **In no event will we be liable for labor of any kind, incidental or consequential damages.** This warranty is extended in lieu of all other expressed or implied warranties, whether oral or written. **Many installation compounds are harmful to brass and metal finishes. The use of any lead-based or acidic curing adhesive, silicone, mastic, or plumber's putty on or near our finished products will void the finish warranty. Use only sealants which are neutral curing and are not reactive with metal and brass finishes.** **Bluewater Manufacturing Corporation** reserves the right to change, modify or alter its products as deemed necessary. This warranty supersedes any other American Faucet & Coatings Corporation warranties, whether oral or written.

*Unless otherwise contrary to state law governing the purchase, **Bluewater Manufacturing Corporation's** liability will not exceed the wholesale price for the **Bluewater Manufacturing Corporation** product considered defective. This warranty gives you specific legal rights, and you may also have other rights which vary from state to state. Some states do not allow exclusion of incidental or consequential damages, so the above limitation may not apply to you.*

LIFETIME WARRANTY ON 1/4 TURN CERAMIC DISC CARTRIDGE

Should the ceramic disc cartridge in your faucet ever fail, **Bluewater Manufacturing Corporation** will replace the failed part free of charge to the original purchaser of the product. Your cost will be a \$15.95 handling and mailing charge. Labor not included. When ordering replacements, denote for widespread or centerset lavatory, Roman Tub, or other. Include age of faucet. (This does not include thermostatic, pressure balance, kitchen or diverter cartridges.)

NOTICE

Bluewater Manufacturing Corporation products are ICC-ES PMG listed and are tested to ASME A112.18.1/CSA B125.1-2011 and ASSE 1016, and comply with NSF/ANSI 61-2011a and NSF372 - 2010 for basin faucet, bar faucets, and kitchen faucets as required.